

# Yonkers, NY

# CURRENTLY PARTY CITY

# 2550 Central Park Avenue

# Central Plaza

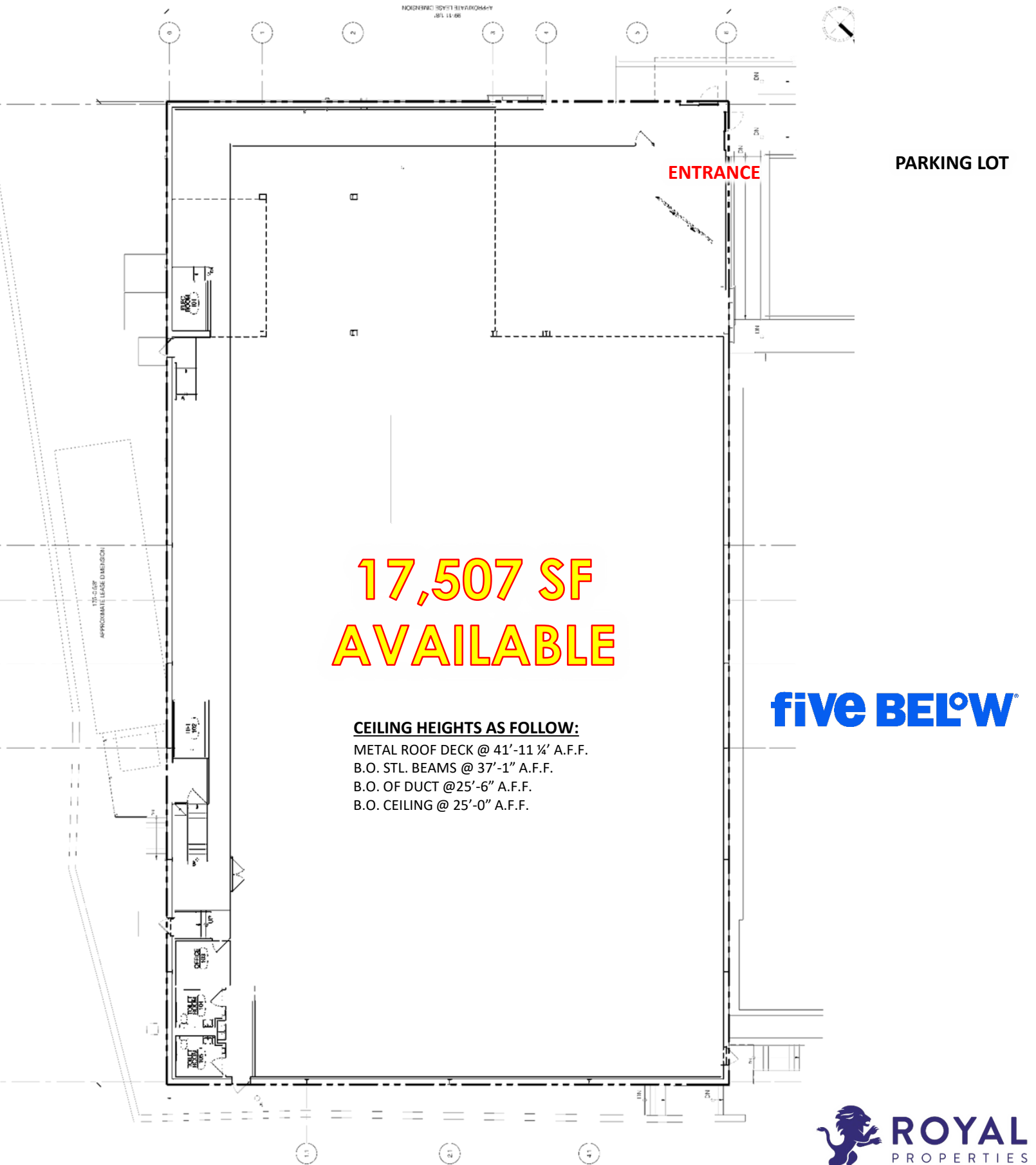

**ENTRANCE**

**PARKING LOT**

**17,507 SF  
AVAILABLE**

**CEILING HEIGHTS AS FOLLOW:**  
METAL ROOF DECK @ 41'-11 1/4' A.F.F.  
B.O. STL. BEAMS @ 37'-1" A.F.F.  
B.O. OF DUCT @ 25'-6" A.F.F.  
B.O. CEILING @ 25'-0" A.F.F.

**five BELOW**



Rear

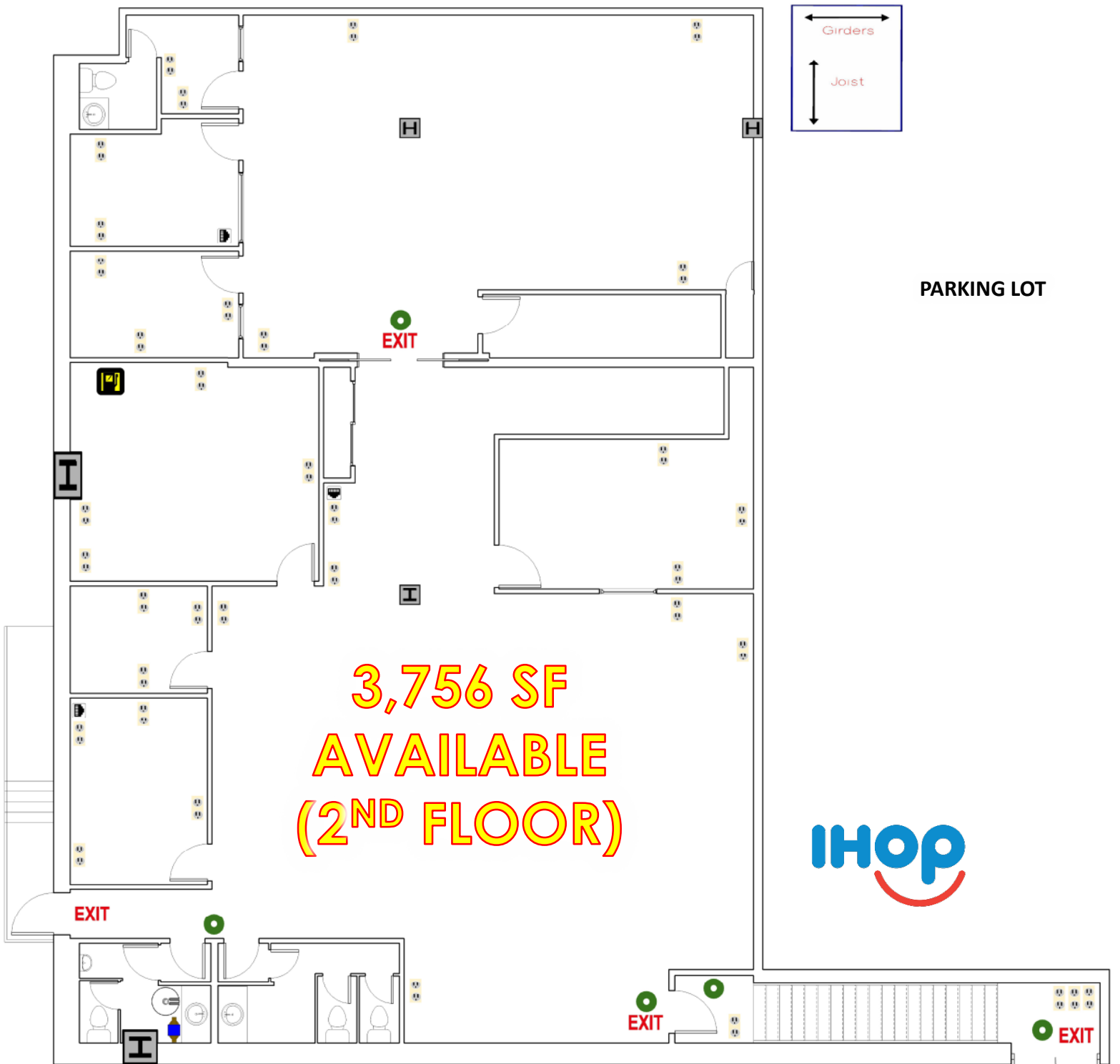

3,756 SF  
AVAILABLE  
(2<sup>ND</sup> FLOOR)

PARKING LOT



ENTRANCE

Front





CENTRAL PARK AVENUE



Residential

